



## Configured Oven Cabinet with Overlay Panel

Use One form for each Appliance

Dealership Name \_\_\_\_\_

Date \_\_\_\_\_

Designer Name \_\_\_\_\_

Phone \_\_\_\_\_

Project Name \_\_\_\_\_

Pricing Program Item # \_\_\_\_\_

Overlay Panels are manufactured with  $\frac{1}{16}$ " reveal on sides, and  $\frac{1}{8}$ " top and bottom (typical door clearances).

Left and Right dimensions of panel must be least  $\frac{11}{16}$ ". Inside edge of cutout is NOT finished.

Cabinet back of appliance opening may require field cut-out.

### Use for **BWD2D** Base Oven Cabinets

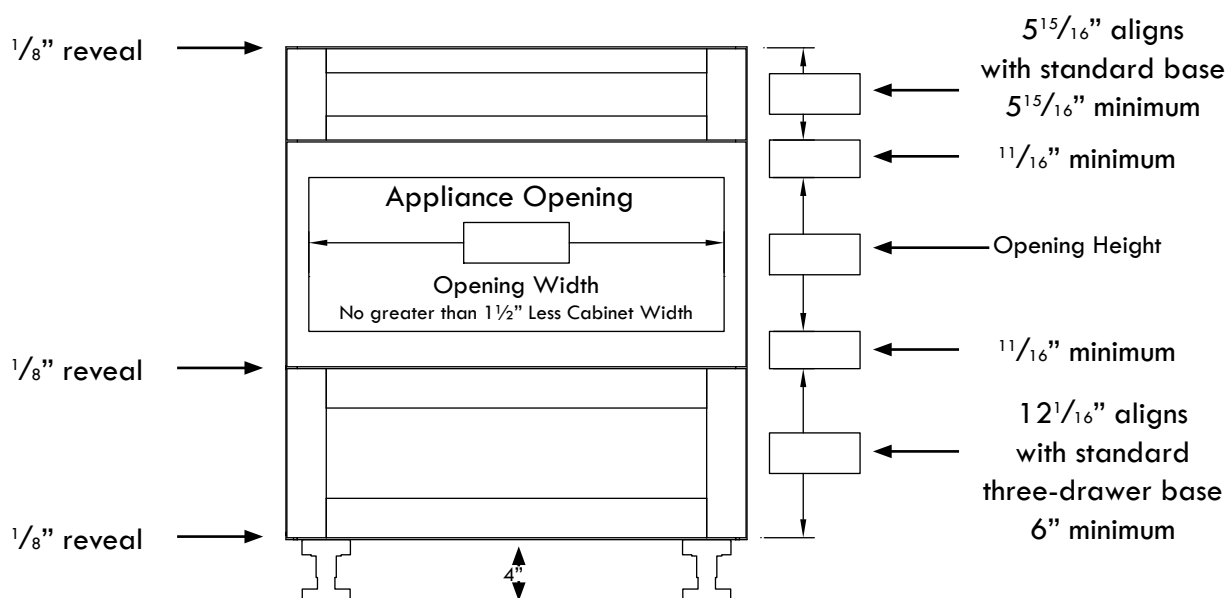

Computed Cabinet Height  
with necessary reveals

Email or Fax Form to:  
customerservice@harmonikitchens.com • 972-227-5267